

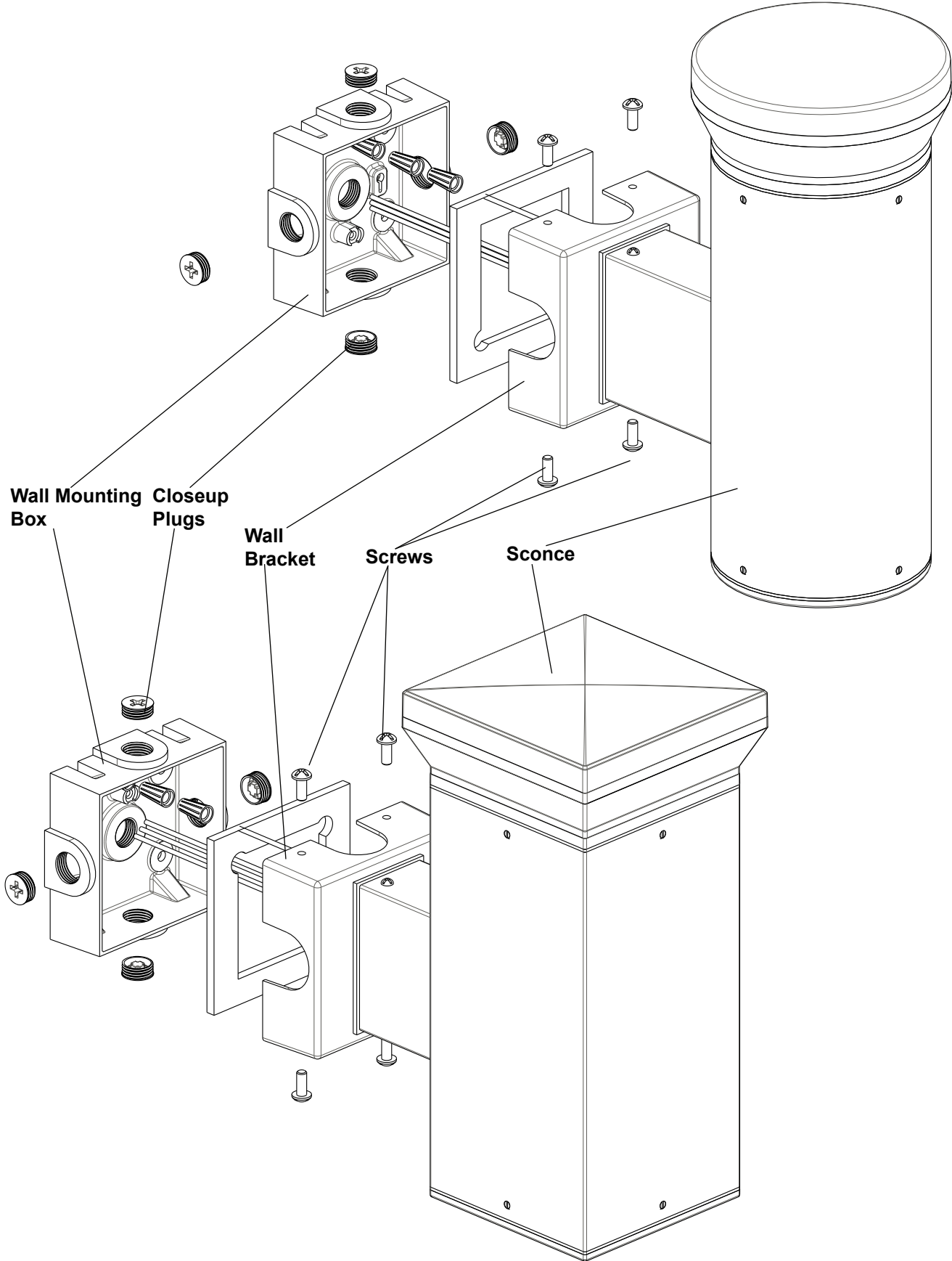

# ARCHITECTURAL SCENCE INSTALLATION INSTRUCTIONS



# ARCHITECTURAL SCONCE INSTALLATION INSTRUCTIONS

## WIRING

Universal voltage driver permits operation at 120V to 277VAC, 50 or 60 Hz.

1. Connect the BLACK fixture lead to the (+) LINE supply lead.
2. Connect the WHITE fixture lead to the (-) COMMON supply lead.
3. Connect the bare copper Ground wire from fixture to supply ground.

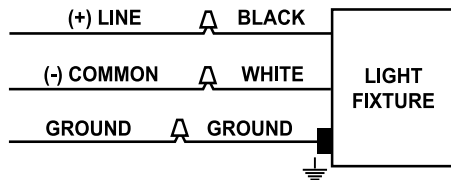

## CLEANING & MAINTENANCE

**CAUTION: Be sure fixture temperature is cool enough to touch. Do not clean or maintain while fixture is energized.**

1. Clean lens with non-abrasive cleaning solution.
2. Do not open the fixture to clean the LED. Do not touch the LED.

## TROUBLESHOOTING

1. Check that the line voltage at the fixture is correct. Refer to wiring directions.
2. Is the fixture is grounded properly?

### WBLED24 Square Sconce 18W Cool LED

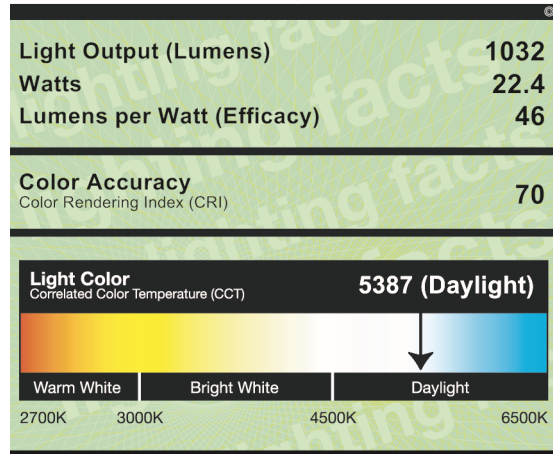

All results are according to IESNA LM-79-2008: *Approved Method for the Electrical and Photometric Testing of Solid-State Lighting*. The U.S. Department of Energy (DOE) verifies product test data and results.

Visit [www.lightingfacts.com](http://www.lightingfacts.com) for the *Label Reference Guide*.

Registration Number: WVMA-NLrQYN (9/25/2013)  
Model Number: WBLED18  
Type: Luminaire - Other

### WBLEDR24 Round Sconce 18W Cool LED

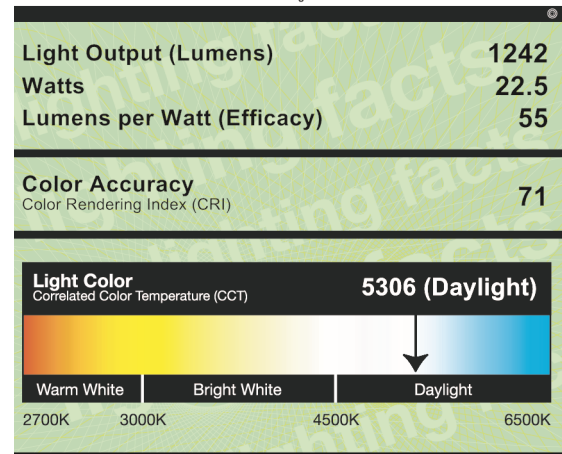

All results are according to IESNA LM-79-2008: *Approved Method for the Electrical and Photometric Testing of Solid-State Lighting*. The U.S. Department of Energy (DOE) verifies product test data and results.

Visit [www.lightingfacts.com](http://www.lightingfacts.com) for the *Label Reference Guide*.

Registration Number: WVMA-Lh41CK (9/25/2013)  
Model Number: WBLEDR18  
Type: Luminaire - Other

**SCONCE Round:** US pat. D675,766, CA Pat. pending, CN ZL201230350184.6, MX pat. pending, TX: pat.pending  
**SCONCE Square:** US pat. D675,767, CA Pat. pending, CN ZL201230350185.0, MX pat. pending, TX: pat.pending

*Note: These instructions do not cover all details or variations in equipment nor do they provide for every possible situation during installation, operation or maintenance.*