

WPLED[®] 52W INSTALLATION INSTRUCTIONS



WPLED52
Standard (15 Deg)



WPLED52
Cutoff (7.5 Deg)



WPLED52
Full Cutoff (0 Deg)

IMPORTANT

READ CAREFULLY BEFORE INSTALLING FIXTURE. RETAIN THESE INSTRUCTIONS FOR FUTURE REFERENCE.

RAB fixtures must be wired in accordance with the National Electrical Code and all applicable local codes. Proper grounding is required for safety. THIS PRODUCT MUST BE INSTALLED IN ACCORDANCE WITH THE APPLICABLE INSTALLATION CODE BY A PERSON FAMILIAR WITH THE CONSTRUCTION AND OPERATION OF THE PRODUCT AND THE HAZARDS INVOLVED.

WARNING: Make certain power is OFF before installing or maintaining fixture. No user serviceable parts inside.

CAUTION: For proper weatherproof function all gaskets must be seated properly and all screws inserted and tightened firmly. Apply weatherproof silicone sealant around the edge of the Wall Box and/or Junction Box. This is especially important with an uneven wall surface. Silicone all plugs and unused conduit entries.

MOUNTING TO A WALL

1. Orient box so that "TOP" is on top.
2. Secure **Wall Mounting Box** to a sturdy wall. Use appropriate mounting hardware such as lag bolts and anchors with washers suitable for the mounting surface.
3. Feed supply wires through **Wall Mounting Box**. Check that **Gasket** is fully sealed.
4. Bring fixture up to the **Wall Mounting Box** and slide the stainless steel **Tether** from the fixture into the **Key Hole Slot** for hands free wiring.
5. Wire the fixture using suitable wire connectors.
6. Place wired fixture over the **Wall Mounting Box** and tighten the **Top Screws**. Now tighten the **Lower Screws**.
7. Tighten **Close Up Plugs** and apply weatherproof silicone sealant to all unused conduit entry points. Also use sealant between the wall and **Wall Mounting Box**.

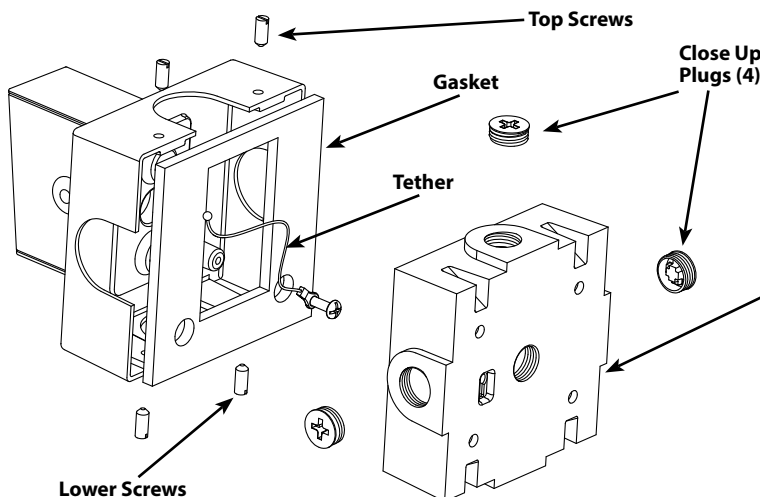
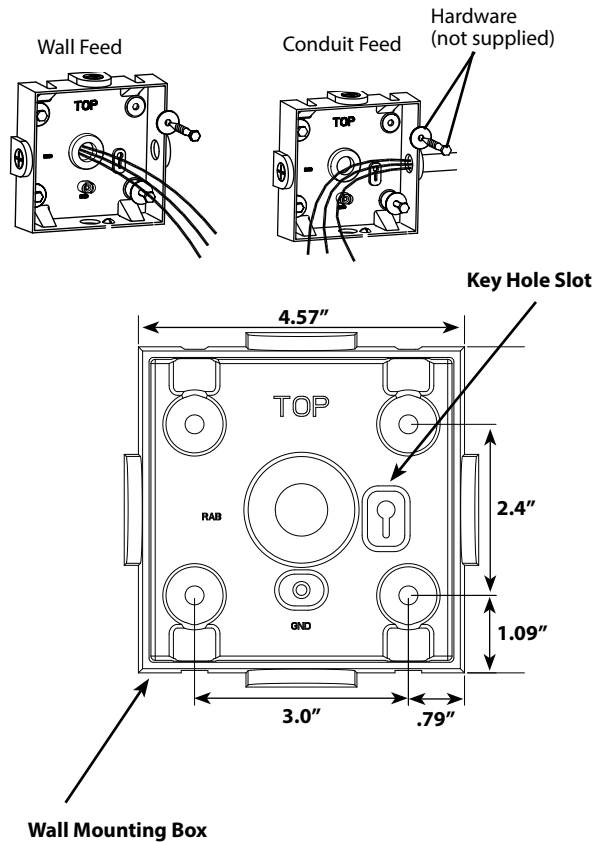

WPLED[®] 52W INSTALLATION INSTRUCTIONS

WIRING

Universal voltage driver permits operation at 120V to 277VAC, 50 or 60 Hz except fixtures factory ordered with a 120V swivel photocell (/PCS) or 277V swivel photocell (/PCS2)

1. Connect the BLACK fixture lead to the (+) LINE supply lead.
2. Connect the WHITE fixture lead to the (-) COMMON supply lead.
3. Connect the bare copper Ground wire from fixture to supply ground.

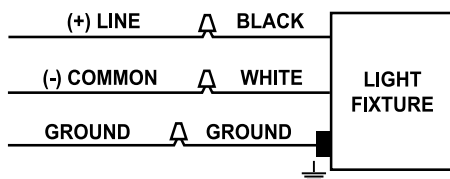

CLEANING & MAINTENANCE

CAUTION: Be sure fixture temperature is cool enough to touch. Do not clean or maintain while fixture is energized.

1. Clean glass lens with non-abrasive glass cleaning solution.
2. Do not open the fixture to clean the LED. Do not touch the LED.

PHOTOCELL INSTALLATION

Photocell may be installed in the field. Apply weatherproof silicone sealant to all plugs and unused conduit entries.

1. Remove close up plug on top of the wall mounting box.
2. Install photocell and wire as per diagram.
3. Use photocell rated for your supply voltage.

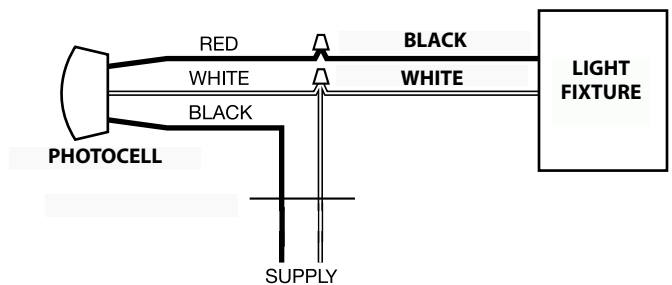

TROUBLESHOOTING

1. Check that the line voltage at the fixture is correct. Refer to wiring directions.
2. Is the fixture grounded properly?
3. Be sure the photocell, if used, is functioning properly.

Patents: US: pat. D653,377

Note: These instructions do not cover all details or variations in equipment nor do they provide for every possible situation during installation, operation or maintenance.

WPLED® 52W INSTALLATION INSTRUCTIONS

WPLED52 Cool

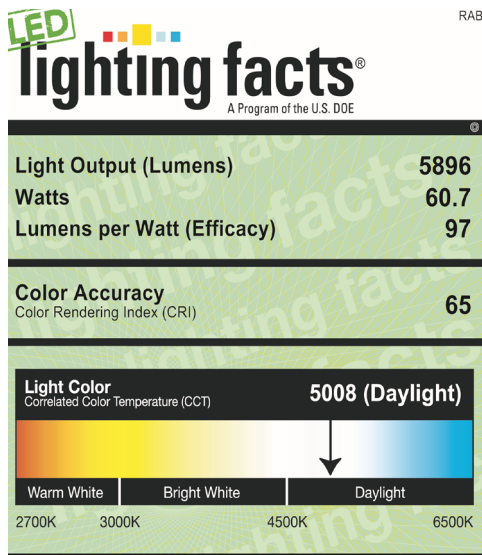

All results are according to IESNA LM-79-2008: Approved Method for the Electrical and Photometric Testing of Solid-State Lighting. The U.S. Department of Energy (DOE) verifies product test data and results.

Visit www.lightingfacts.com for the *Label Reference Guide*.

Registration Number: WVMA-ZQ4S5G (12/10/2013)
Model Number: WPLED52 [Upgrade : 12/31/2013]
Type: Luminaire - Area/Roadway

WPLEDC52 Cool

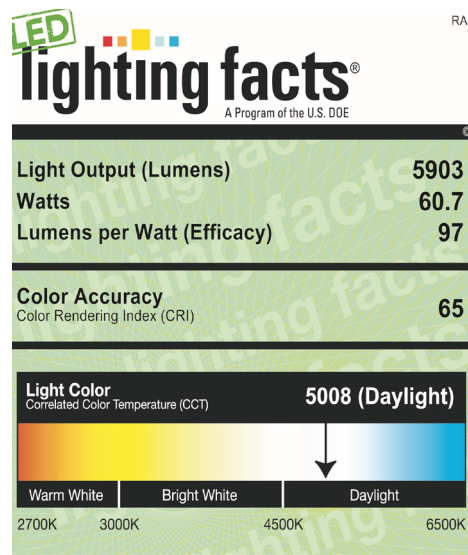

All results are according to IESNA LM-79-2008: Approved Method for the Electrical and Photometric Testing of Solid-State Lighting. The U.S. Department of Energy (DOE) verifies product test data and results.

Visit www.lightingfacts.com for the *Label Reference Guide*.

Registration Number: WVMA-UAQDDL (12/10/2013)
Model Number: WPLEDC52 Upgraded 03/2012 [Upgrade : 12/31/2013]
Type: Luminaire - Area/Roadway

WPLEDFC52 Cool

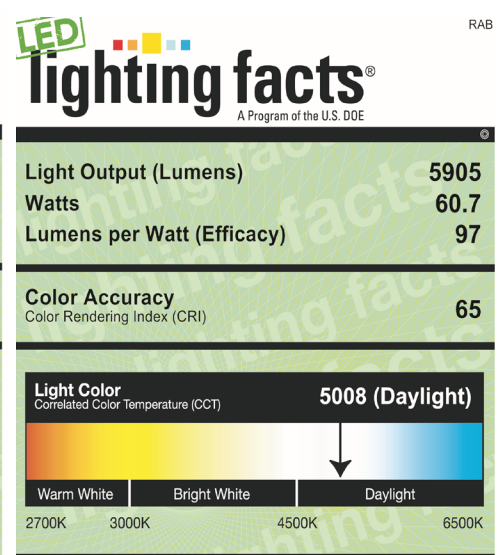

All results are according to IESNA LM-79-2008: Approved Method for the Electrical and Photometric Testing of Solid-State Lighting. The U.S. Department of Energy (DOE) verifies product test data and results.

Visit www.lightingfacts.com for the *Label Reference Guide*.

Registration Number: WVMA-YV4RXY (12/10/2013)
Model Number: WPLEDFC52 [Upgrade : 12/31/2013]
Type: Luminaire - Area/Roadway

WPLED52N Neutral

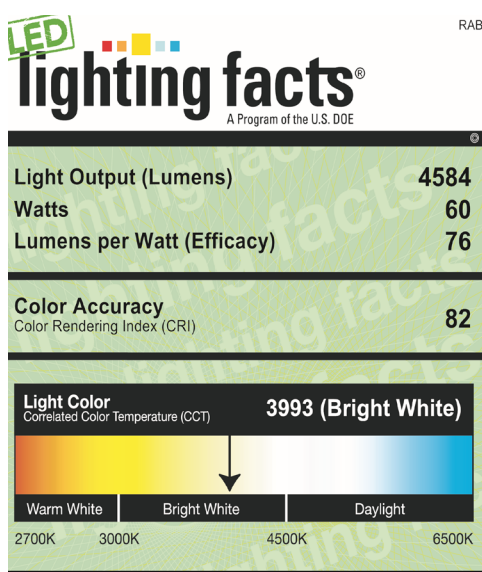

All results are according to IESNA LM-79-2008: Approved Method for the Electrical and Photometric Testing of Solid-State Lighting. The U.S. Department of Energy (DOE) verifies product test data and results.

Visit www.lightingfacts.com for the *Label Reference Guide*.

Registration Number: WVMA-BPWXXC (12/10/2013)
Model Number: WPLED52N [Upgrade : 12/31/2013]
Type: Luminaire - Area/Roadway

WPLEDC52N Neutral

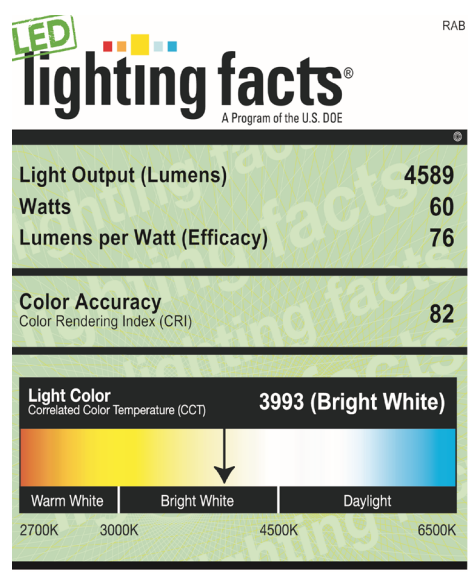

All results are according to IESNA LM-79-2008: Approved Method for the Electrical and Photometric Testing of Solid-State Lighting. The U.S. Department of Energy (DOE) verifies product test data and results.

Visit www.lightingfacts.com for the *Label Reference Guide*.

Registration Number: WVMA-SQB6S2 (12/10/2013)
Model Number: WPLEDC52N [Upgrade : 12/31/2013]
Type: Luminaire - Area/Roadway

WPLEDFC52N Neutral

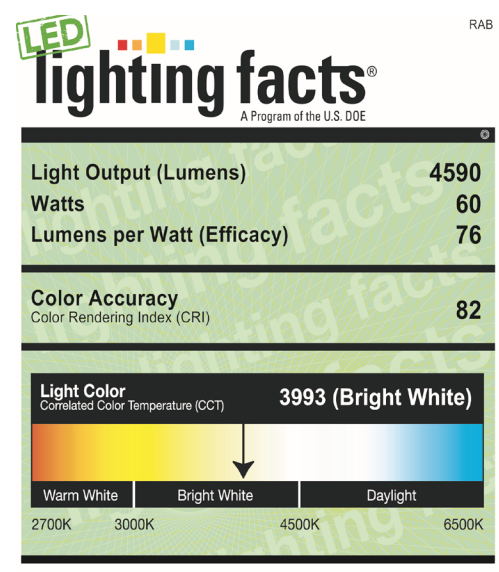

All results are according to IESNA LM-79-2008: Approved Method for the Electrical and Photometric Testing of Solid-State Lighting. The U.S. Department of Energy (DOE) verifies product test data and results.

Visit www.lightingfacts.com for the *Label Reference Guide*.

Registration Number: WVMA-CJ55GU (12/10/2013)
Model Number: WPLEDFC52N [Upgrade : 12/31/2013]
Type: Luminaire - Area/Roadway

ALED[®] 52 & WPLED[®] 52 BILEVEL INSTRUCTIONS

IMPORTANT

READ CAREFULLY BEFORE INSTALLING FIXTURE. RETAIN THESE INSTRUCTIONS FOR FUTURE REFERENCE.

Fixtures must be wired in accordance with the National Electrical Code and all applicable local codes. Proper grounding is required for safety. THIS PRODUCT MUST BE INSTALLED IN ACCORDANCE WITH THE APPLICABLE INSTALLATION CODE BY A PERSON FAMILIAR WITH THE CONSTRUCTION AND OPERATION OF THE PRODUCT AND THE HAZARDS INVOLVED.

WARNING: Make certain power is OFF before installing or maintaining fixture. No user serviceable parts inside.

MOUNTING ARM ON FIXTURE

1. Bi-level fixtures have LED's wired in pairs. The two pairs are shown below.
2. Each pair has leads brought through the arm and labeled.
3. Use the pairs for switching as needed in your application.

